



SAVEWO



Savewo



savewohk

www.savewo.com

CARCELL

汽車啟停電池 (LiFePO₄)



B19

12.8V 54Ah
690Wh 800A

AUTO START & STOP LiFePO₄ Lithium Battery

使用說明書
User Manual

使用前請仔細閱讀本說明
請妥善保存，以備參考



警告

請按照說明書上的安全提示進行操作，
否則有可能導致起火、漏電或者其他傷害。

更新日期：20250728

目 錄

安全注意事項.....	P.1-4
使用注意事項.....	P.5
產品規格.....	P.6
LED 電量顯示	P.6
產品結構	P.7
電池更換方法.....	P.8-9
保養和檢查方法	P.10
保用條款	P.10-11



安全注意事項

請務必遵守

為了防止對人身和財產的危害，以下標示必須遵守的注意事項。
並根據錯誤使用導致的危害或損害的嚴重程度分類標示說明。



危險 表示「可能導致死亡或嚴重傷害」的內容。



警告 表示「可能導致死亡或傷害」的內容。



注意 表示「可能導致輕傷或財產損害」的內容。

以下圖示標示必須遵守的內容

禁止的標記



必須遵守的標記



注意的標記





危險

為了防止對人身和財產的危害
以下標示必須遵守的注意事項

表示「可能導致死亡或嚴重傷害」的內容。



請勿用於汽車發動機
啟動以外的用途



請勿靠近明火

△ 電池會釋放氫氣而引起爆炸危險。

禁止明火



不可在密閉環境中
使用或存放



請勿在纜線接頭和電池
接頭腐蝕後繼續使用

火花可能引起爆炸危險。



請確實拴緊
電池和電纜接頭

接觸不良可能導致引起爆炸和火災。



請勿用金屬工具等接觸
電正負端子(引至短路)

可能導致引起爆炸和火災。



佩戴護目鏡

操作時請佩戴護目鏡
和橡膠手套



兒童禁止

不要讓不熟悉操作方法或
危險性的人(如兒童等)接觸

靜電可能導致火災爆炸，
電池液可能導致失明和燙傷。



請正確使用救援跳線

接錯可能導致引起爆炸和火災。

● 詳情請參閱第8、9頁。



正確使用充電器

請按照充電器的使用說明正確操作
錯誤的操作可能引起爆炸和火災。



請勿倒置、側放、傾斜、
摔落或受到撞擊



警告

為了防止對人身和財產的危害
以下標示必須遵守的注意事項

表示「可能導致輕傷或財產損害」的內容。



請勿直接連接 電池到電氣設備

電線可能會損壞並導致車輛火災。



處理電池時要注意靜電

靜電可能導致火災或爆炸。

- 在處理之前，請觸碰金屬（車身）以釋放靜電。



請勿使用乾布等 乾燥的材料清潔電池

靜電可能引起爆炸和火災。

- 請使用濕潤的布來清潔電池。



確保使用安裝固定 裝置固定電池

如果安裝不足，可能導致電池損壞、洩漏、火災、引火或爆炸。



不要改裝或拆卸電池

這可能引起爆炸和火災。



安裝電纜時 不要顛倒正負極

這可能會導致電子元件損壞、燒損或火災。



電池只安裝在 適配的車輛上

如果連接端鬆動，電池固定鬆脫，連接電纜受損等，可能會引起爆炸、火災和物品損壞的風險。



更換、維護和檢查電池時，請將 車輛引擎關閉，燈光關閉，並按 正確順序操作

如果操作順序錯誤，可能引起爆炸和火災。

- 詳細信息請參考P7~9。



注意

為了防止對人身和財產的危害
以下標示必須遵守的注意事項

表示「可能導致輕傷或財產損害」的內容。



**使用充電器充電時，
請使用標準充電電流**
否則可能引起爆炸和火災。



如果出現異常，如異味、
液體洩漏、變形等，請停止使用
這可能引起爆炸和火災。
●請諮詢銷售商。



請勿在工作溫度範圍外使用
冷凍或過熱可能會導致損壞或變形。
工作溫度範圍：-10°C至+65°C



**請勿將電池放置在接觸
到水或海水的環境中使用**
否則可能導致損壞或火災。



**救援車的電池應使用與電池耗
盡的車輛相同的電壓。**
可能會導致短路。



**電池的保護蓋和端子蓋
應以原本的方式安裝**
安裝不正確可能會導致爆炸危險
(有些車輛沒有保護蓋)。



處理重型電池時要小心
否則導致背痛、跌倒受傷或
財產損失。



**若電池上有手柄
請勿握住手柄轉動電池**
電池可能會掉落並造成人身安全
或財產損失。



不要隨便棄置舊電池
否則可能會導致事故。
請將舊電池退回到您購買電池的商店。



使用注意事項

1 電池用途

此電池用於汽車發動機啟動。請勿在其他用途（如農業機械、建築機械、船舶、電動車輛、焊接機、電源等）中使用。如果需要在預期用途之外使用，請與本公司或銷售商諮詢。

- 請確認車輛上已安裝的電池和您購買的電池具有相同的尺寸、極性和形狀。
- 如果車輛配備了兩個電池，請同時更換為相同型號和具有相同使用時間的電池。

2 攜帶和儲存

- 請在不倒置、不橫放、不傾斜、不摔落和不受衝擊的狀態下攜帶和存放。
- 避免高溫、高濕、雨霧、塵埃、直射陽光，並將其儲存在通風良好、不會浸水或淹沒的地方。
- 請將電池存放在兒童無法觸及的地方。
- 不要靠近明火或造成短路。
- 在儲存期間，電池會自然放電並且無法使用。購買後請盡快使用。

3 預防電池耗盡

電池在行駛過程中會充電，但在不行駛時會逐漸放電，可能導致電池耗盡。此外，行駛距離較短、交通擁堵較多、怠速較多等情況下，可能由於行駛充電不足而導致電池更容易耗盡。請盡量每週行駛2小時以上，給電池充電。



注意事項

- 電池出廠時為半充電狀態，使用前需將電池充滿電。
- 若電池出現異味、冒煙、鼓包、溫度異常等情況，應立即停止充電並送去售後服務中心。
- 售後服務：電池若長期不使用，應每5個月充電一次，以免電池過度失電，影響壽命或損壞。

本產品不預期供生理、感知、心智能力、經驗或知識不足之人士（包含孩童）使用。

B19

AUTO START & STOP LiFePO₄ Lithium Battery

汽車啟停電池 (LiFePO₄)

產品型號	:	CARCELL-B19
峰值電流	:	800A
額定能量	:	690Wh
容量	:	54Ah
電壓	:	12.8V (Max 14.6V)
工作溫度	:	-10°C to 65°C
尺寸	:	197x131x193mm
重量	:	6.2kg
電池種類	:	磷酸鐵鋰電池
電極方向配置	:	0+1
電極尺寸	:	標準+小型
保養	:	3年
充放循環次數	:	3000

LED 電量顯示



電池電量小於5%



電池電量 5% 至 10%



電池電量 10% 至 30%



電池電量 30% 至 70%



電池電量大於70%

產品結構

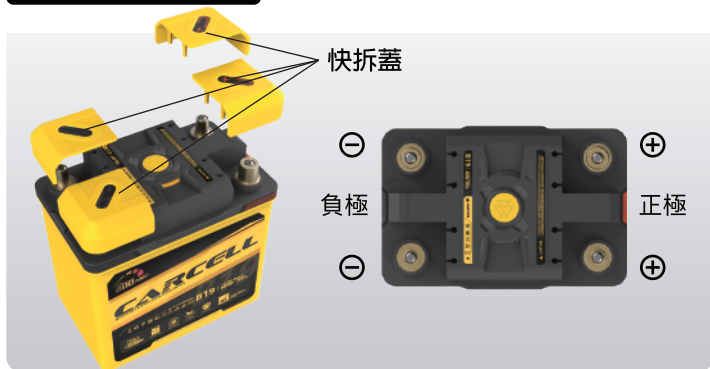

首創四極專利設計



小型 電極
Small Terminals



標準 電極
Standard Terminals

可互換 標準 + 小型 電極



電池更換方法

在更換電池前，請諮詢銷售商，並務必遵循車輛的使用說明書和維修手冊等，以自行承擔責任進行更換。我們不對由於電池更換而導致的車輛故障承擔責任。

※如果從電池上拆下電纜端子，可能需要重新設置電子設備，如電動窗等，並且可能會導致已安裝的電子設備的信息丟失。

- 1. 處理**
- ⚠ 在處理電池之前，請觸碰金屬（車身）以釋放靜電。
 - ⚠ 在處理電池時，請戴上防護眼鏡和橡膠手套。

2. 拆卸電池

請按照以下順序進行拆卸：

1. 停車並關閉引擎，拔出鑰匙。
請將燈等開關置於“OFF”（關閉）位置。
2. 拆下負極 ⊖ 電纜端子。
3. 拆下正極 ⊕ 電纜端子。
4. 拆下電池安裝支架。
5. 取下電池。

如果電纜端子髒污或損壞，可另行購買。

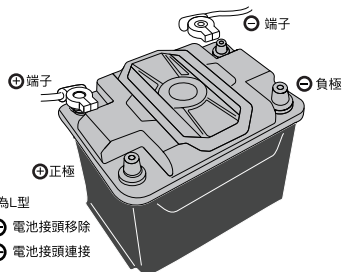

3. 安裝電池

- 注意不要過緊固定安裝支架和電纜端子。
過緊固定可能導致電池、端子變形、損壞。
- 請確保電纜端子固定後不能旋轉。

請按照以下順序安裝：

1. 將電池放在安裝台上，使用安裝支架牢固地固定。

※如果新電池上有端子蓋，請將端子蓋取下，並將其安裝在已拆下的電池上。

※如果新電池上有把手、繩帶等，請在安裝時拆下。

※如果電池有保護套，請將其重新安裝到原位。

2. 將正極 ⊕ 電纜端子連接到電池的正極端子上，緊固螺母以確保牢固固定。

3. 將負極 ⊖ 電纜端子連接到電池的負極端子上，緊固螺母以確保牢固固定。

※為了防止電纜端子的金屬部分生鏽，建議塗抹防銹脂。

4. 如果車輛上有端子蓋，請重新安裝端子蓋到原位。

※請確保不要遺忘工具等物品在發動機艙等地方。

電池電量耗盡時

使用啟動電纜啟動發動機 ※本文中的方法是一般汽車的示例。請參考車輛的使用說明書以獲取詳細信息。

- 1 請求一輛具有相同電壓（12V或24V）和相同容量的救援車輛來協助故障車輛（電池沒電的車輛）。

- 2 故障車輛和救援車輛都應將發動機鑰匙置於「OFF」（關閉）位置。

- 3 使用啟動電纜，按照下圖的順序連接 ①→②→③→④
※請確保將 ④ 連接到車輛上遠離電池未噴漆的固定金屬部位（螺栓、發動機主體上的鉤子等）。請確保牢固固定啟動電纜，不要讓它們鬆開，並確保它們不會捲入冷卻風扇或皮帶中。

- 4 啟動救援車的發動機並將發動機轉速略微提高。

- 5 啟動故障車的發動機。

- 6 最後，按照與連接時相反的順序 ④→③→②→① 拆下啟動電纜。

- 7 請前往最近的電池銷售店或汽車銷售店等進行檢查。

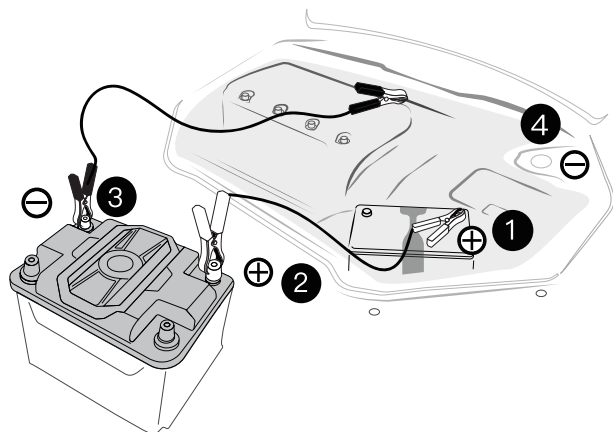

保養和檢查方法

1 電池清潔

用沾水的布清潔。

※請勿用乾布擦拭，靜電可能會引起著火和爆炸。

※請勿使用汽油、稀釋劑等有機溶劑或清潔劑來清潔產品。

2 檢查安裝支架和電纜端子

1. 檢查電池安裝支架和電纜端子是否有鬆動。

2. 若有鬆動，擰緊螺母並固定牢固。



保用條款

- 產品保修服務只適用於救世官網或官方授權經銷商出售之產品。
- 維修產品時客戶需出示由 Savewo Energy Limited 或官方授權經銷商所發出之正式發票予技術員查閱，如客戶未能出示有效文件，則須繳付所需之維修費用。（詳情請參閱條款及細則。）
- 相關詳情及條款細則，請參閱 Savewo 網址：
<https://www.savewo.com/zh-hk/warranty>
- 如有任何爭議，Savewo Energy Limited 會保留最終決定權。



條款及細則

Savewo Energy Limited（下稱「本公司」）將提供三十六個月有限保修服務（由發票上的日期起計）。超過這期間者，產品保修服務將收取維修費用。

1. 本公司對於任何因產品不適當地使用而導致產品之故障、損壞、停頓，或引致任何人士和財產的直接或間接損失及破壞，本公司概不負責。
2. 使用保修服務時，客戶須自行將產品送往客戶服務中心或指定地點，並於同一地點取回。
3. 在正常使用情況下，本公司將在保養期內為故障之產品提供免費保修服務。（產品表面、機殼、損耗性零件、配件及消耗品除外）
4. 下列項目並不包括於保修範圍內，客戶須另付所需的服務費用。
 - (a) 曾被非授權人士進行改裝、更改或修理的產品。
 - (b) 曾經被不適當或疏忽使用、用後疏於保養、不正常供電或電壓不正常、意外、天災或因昆蟲、外物、液體入侵、腐蝕、正常使用損耗或外來因素而造成損壞的產品。
 - (c) 未遵守使用說明書記載的方法使用，造成產品損傷。
5. 所有資料如有任何更改，恕不另行通知。如有任何爭議，本公司保留最終決定權。

以下情況不適用保證：

1. 由於燈光等被忘記關閉導致電池放電，並通過充電恢復的情況。
2. 如果出現以下使用上的濫用、不適當使用或疏忽，包括但不限於：
 - a. 由於電氣設備故障、缺陷、改裝等原因導致的情况。
 - b. 對電池進行改裝或增加過大負載的情況。
 - c. 電池損壞的情況。
 - d. 過充或過放電或長時間保持放電狀態的情況。
 - e. 長時間不使用車輛，由於停車期間的電流消耗而導致放電的情況。
 - f. 逆極性充電的情況。
3. 如果問題源自汽車本身的原因，包括但不限於：
 - a. 調整器的設置電壓超出標準範圍，導致過充電。
 - b. 反覆發生電池放電的情況。
4. 無法檢查出問題發生的車輛的情況。
5. 天災如地震、颱風、風水災害，以及火災、事故、動亂等情况。
6. 如果電池被安裝到保證書未涵蓋的車輛上。

**為保證您能充分了解並正確使用本產品，
請您仔細閱讀說明書。建議妥善保存，以便需要時查閱。**
※產品更新有機會造成說明書內容有差異，請以實物為準。

客戶服務及售後支援專線

救世客戶服務中心

地址：香港荃灣德士古道266-270號 金泰線廠1樓

1/F, 266-270 Texaco Road, Tsuen Wan, N.T., Hong Kong

電話：+852 5503 2370

www.savewo.com



Savewo



savewohk



CARCELL



www.savewo.com | store.savewo.com

☎ +852 6487 8597  Savewo 救世  savewohk



SAVEWO



Savewo



savewohk

www.savewo.com

CARCELL



B19

12.8V 54Ah
690Wh 800A

AUTO START & STOP LiFePO₄ Lithium Battery

User Manual

Please read this instruction completely and keep it properly



WARNING

Please follow the safety instructions contained in this user manual; otherwise, it may result in fire, leakage, or other damages.

Latest Update: 20250728

Contents

Safety Precautions	P.1-4
Usage Instructions.....	P.5
Product Specifications.....	P.6
LED Battery Indicator.....	P.6
Product Structure	P.7
Battery Replacement Method	P.8-9
Maintenance and Inspection Instructions	P.10
Warranty Terms	P.10-11



Safety Precautions

Please Follow Carefully

To prevent harm to personal safety or property, the following safety precautions must be observed. These notices are categorized based on the level of potential harm or damage caused by improper use.



DANGER

Indicates a situation that may result in death or serious injury.



WARNING

Indicates a situation that may result in death or injury.



DANGER

Indicates a situation that may result in minor injury or property damage.

The following symbols indicate important instructions:

Prohibited Actions



Mandatory Actions



Caution Required





DANGER

To prevent harm to personal safety or property, the following precautions must be strictly observed

Indicates a situation that may result in death or serious injury.



Do not use for purposes other than starting a car engine.



No open flames

Keep away from open flames.

⚠ The battery may release hydrogen gas, which can cause an explosion hazard.



Do not use or store in enclosed spaces.



Do not continue to use if cable or battery terminals are corroded.

Sparks may lead to explosion hazards.



Ensure battery and cable terminals are securely tightened.

Loose connections may cause explosions or fire.



Do not touch battery terminals (positive and negative) with metal tools or objects.

This may cause a short circuit, resulting in explosion or fire.



Wear goggles

Wear safety goggles and rubber gloves during operation.



Not for Children

Keep out of reach of individuals unfamiliar with operation or the risks involved (e.g., children).

Static electricity may trigger fire or explosion; battery fluid may cause blindness or burns.



Use booster cables properly.

Incorrect connections may lead to explosion or fire.

● For details, refer to pages 8–9.



Use the charger correctly.

Follow the charger's instruction manual carefully.



Do not place the product upside down, on its side, tilted, dropped, or subject it to impact.



WARNING

To prevent harm to personal safety or property, the following precautions must be strictly observed

Indicates a situation that may result in death or injury.



Do not connect the battery directly to electrical devices.

The wiring may be damaged and cause a vehicle fire.



Handle the battery with care to avoid static electricity.

Static discharge may lead to fire or explosion.

- Before handling, touch a metal surface (such as the vehicle body) to discharge static electricity.



Do not clean the battery with dry cloths or other dry materials.

Static electricity may cause fire or explosion.

- Use a damp cloth to clean the battery.



Always secure the battery using proper mounting hardware.

Insufficient installation may result in battery damage, leakage, fire, ignition, or explosion.



Do not modify or disassemble the battery.

Doing so may cause explosion or fire.



Do not reverse the polarity (Positive / Negative terminals) when connecting cables.

This may damage electronic components, cause overheating, or result in fire.



Install the battery only in compatible vehicles.

Loose connections, improper mounting, or damaged cables may lead to explosion, fire, or property damage.



When replacing, maintaining, or inspecting the battery, be sure to turn off the vehicle engine and lights, and follow the correct procedure in the specified order.

Failure to do so may result in explosion or fire.

- For detailed instructions, refer to pages 7–9.



CAUTION

To prevent harm to personal safety or property, the following precautions must be strictly observed

Indicates a situation that may result in minor injury or property damage.



Do not connect the battery directly to electrical devices.

Failure to do so may cause explosion or fire.



If any abnormality occurs—such as unusual odor, fluid leakage, or deformation—stop using the battery immediately.

Continued use may result in explosion or fire.

● Please contact your dealer for assistance.



Do not use the battery outside the recommended operating temperature range.

Exposure to freezing or excessive heat may result in damage or deformation.

Operating temperature range: -10°C to +65°C



Do not use or store the battery in environments where it may come into contact with water or seawater.

Doing so may cause damage or fire.



The booster (rescue) vehicle must use a battery with the same voltage as the discharged vehicle.

Mismatched batteries may cause a short circuit.



Battery protection covers and terminal caps must be installed as originally designed.

Improper installation may pose an explosion risk.
(Note: Some vehicles may not be equipped with protective covers.)



Handle heavy batteries with care.

Improper handling may lead to back injury, falls, or property damage.



If the battery is equipped with a handle, do not use the handle to rotate or twist the battery.

This may cause the battery to drop, resulting in personal injury or property damage.



Do not dispose of old batteries improperly.

Improper disposal may result in accidents or environmental harm.

Please return used batteries to the store where they were purchased.



Usage Instructions

1 Battery Application

This battery is intended for use in starting automobile engines. Do not use it for other purposes, such as agricultural machinery, construction equipment, marine vessels, electric vehicles, welding machines, or as a power supply. If use beyond the intended purpose is required, please consult the manufacturer or your dealer.

- Please ensure that the battery installed in your vehicle is the same size, polarity, and shape as the battery you have purchased.
- If your vehicle is equipped with two batteries, both must be replaced at the same time with batteries of the same model and similar usage duration.

2 Carrying and Storage

- Carry and store the battery in an upright position. Do not place it upside down, on its side, tilted, dropped, or subjected to impact.
- Avoid high temperatures, high humidity, rain, fog, dust, and direct sunlight. Store in a well-ventilated area, protected from water immersion or flooding.
- Keep the battery out of reach of children.
- Do not place the battery near open flames or allow it to short circuit.
- The battery will naturally discharge over time during storage and may become unusable. Please use the battery as soon as possible after purchase.

3 Preventing Battery Drain

The battery recharges while the vehicle is in motion, but will gradually discharge while the vehicle is not running. This may result in a dead battery. In conditions such as short-distance driving, frequent traffic congestion, or extended idling, the battery may not receive sufficient charge and will be more prone to discharge. It is recommended to drive the vehicle for at least 2 hours per week to maintain battery charge.



Important Notes

- The battery is shipped in a semi-charged state. Please fully charge the battery before initial use.
- If you notice any unusual odor, smoke, swelling, or abnormal temperature, immediately stop charging and bring the battery to an authorized service center.
- After-sales service: If the battery will not be used for an extended period, it should be charged once every 5 months to prevent excessive discharge, which may shorten battery life or cause damage.

This product is not intended for use by persons (including children) with reduced physical, sensory, or mental capabilities, or lack of experience and knowledge.

B19

AUTO START & STOP LiFePO₄ Lithium Battery

Product Model	: CARCELL-B19
Peak Current	: 800A
Rated Energy	: 690Wh
Capacity	: 54Ah
Voltage	: 12.8V (Max 14.6V)
Operating Temperature	: -10°C to 65°C
Dimensions	: 197x131x193mm
Weight	: 6.2kg
Battery Type	: Lithium iron phosphate battery
Terminal Configuration	: 0+1
Terminal Size	: Standard + Small
Maintenance	: 3 Years
Charge/Discharge Cycle Life	: 3000

LED Battery level display



Battery level
below 5%



Battery level
between 5% and 10%



Battery level
between 10% and 30%



Battery level
between 30% and 70%



Battery level
above 70%

Product Structure

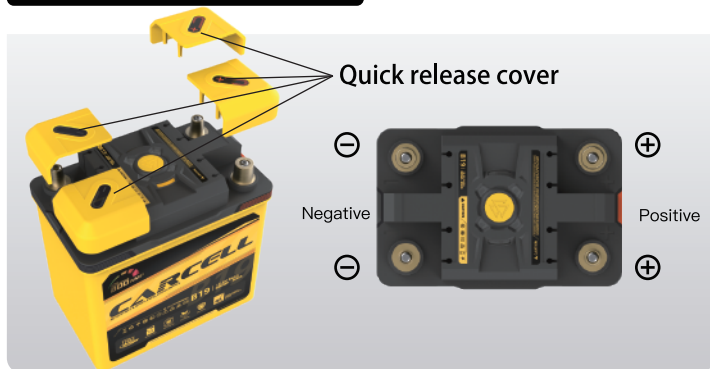

Pioneering Quadrupole Patented Design



Small Terminals



Standard Terminals

Changeable **Standard + Small** terminals



Battery Replacement Method

Before replacing the battery, consult your dealer and be sure to follow the vehicle's owner's manual and service manual. Proceed at your own risk. We are not responsible for any vehicle malfunctions resulting from battery replacement.

※ If the battery cables are disconnected, certain electronic devices (such as power windows) may require reinitialization, and some installed settings or data may be lost.

1. Handling

- ⚠ Before handling the battery, touch a metal surface (such as the vehicle body) to discharge any static electricity.
- ⚠ Wear protective goggles and rubber gloves when handling the battery.

2. Battery Removal

Please follow the steps below for safe removal:

1. Park the vehicle, turn off the engine, and remove the key.
Ensure all switches (e.g., lights) are in the OFF position.
2. Disconnect the negative \ominus battery cable terminal.
3. Disconnect the positive \oplus battery cable terminal.
4. Remove the battery mounting bracket.
5. Carefully lift out the battery.

If cable terminals are dirty or damaged, replacements are available for purchase.

Illustration: L-Type Terminal

- Removal from \ominus Terminal
- Removal from \oplus Terminal

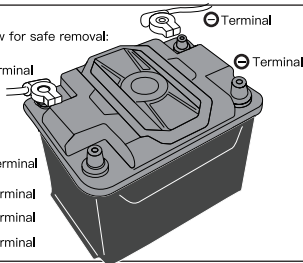

3. Battery Installation

- Be careful not to overtighten the mounting bracket or cable terminals. Excessive force may cause deformation or damage to the battery or terminals.
- Ensure the cable terminals are firmly secured and do not rotate after installation.

Please follow the installation sequence below:

1. Place the battery onto the mounting platform and securely fasten it using the mounting bracket.
 - ※ If the new battery has terminal caps, remove them and install them onto the old battery.
 - ※ If the new battery has handles, straps, or similar accessories, remove them before installation.
 - ※ If the battery includes a protective cover, reinstall it in its original position.



2. Connect the positive \oplus cable terminal to the battery's positive terminal.
Tighten the nut to ensure a secure connection.



3. Connect the positive \ominus cable terminal to the battery's positive terminal.
Tighten the nut to ensure a secure connection.
 - ※ To prevent corrosion of the metal parts on the cable terminals, it is recommended to apply anti-corrosion grease.



4. If your vehicle is equipped with terminal covers, reinstall them in their original position.
 - ※ Ensure that no tools or other objects are left behind in the engine compartment.

When the Battery is Depleted

Starting the Engine with Jumper Cables

※ The procedure described below is a general example for standard vehicles.
Please refer to your vehicle's owner's manual for specific instructions.

- 1 Request assistance from a rescue vehicle that has the same voltage (12V or 24V) and similar battery capacity as the disabled vehicle.



- 2 Make sure both vehicles have their ignition keys in the OFF position.



- 3 Using jumper cables, connect the terminals in the following order: ① → ② → ③ → ④
※ For step ④, connect to an unpainted, fixed metal part of the disabled vehicle, located away from the battery – such as a bolt or hook on the engine block. Ensure the jumper cables are securely connected and not loose. Make sure the cables do not get caught in the cooling fan or belts.



- 4 Start the engine of the rescue vehicle and slightly increase the engine RPM.



- 5 Start the engine of the disabled vehicle.



- 6 Finally, remove the jumper cables in reverse order: ④ → ③ → ② → ①



- 7 After starting, please visit the nearest battery dealer or vehicle service center for a proper inspection.

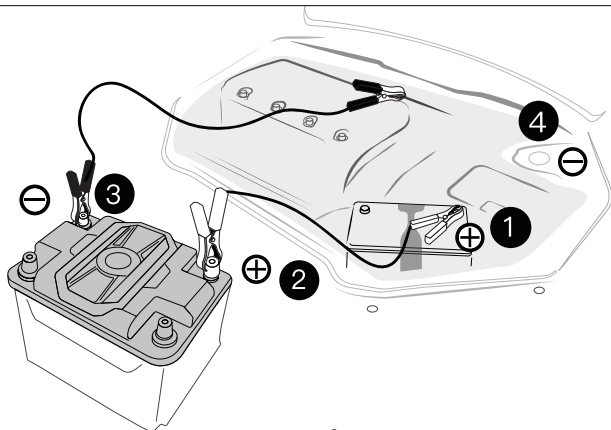

Maintenance and Inspection Instructions

1 Battery Cleaning

Wipe the battery with a damp cloth.

- ※ Do not use a dry cloth, as static electricity may cause fire or explosion.
- ※ Do not use gasoline, thinners, or other organic solvents or cleaners to clean the product.

2 Inspecting the Mounting Bracket and Cable Terminals

1. Check if the battery mounting bracket and cable terminals are loose.
2. If any looseness is found, tighten the nuts to ensure a secure fit.



Warranty Terms

- Warranty coverage applies only to products sold via the official Savewo website or authorized dealers.
- When requesting repair service, customers must present a valid official invoice issued by Savewo Energy Limited or an authorized dealer for verification by our technician. If a valid document cannot be provided, repair service fees will be charged accordingly. (For details, please refer to the Terms and Conditions.)
- For full terms and additional details, please visit the official Savewo website: <https://www.savewo.com/zh-hk/warranty>
- In the event of any dispute, Savewo Energy Limited reserves the right of final decision.



Terms and Conditions

Savewo Energy Limited ("The Company") provides a warranty period of 36 months from the date of purchase. Repair and maintenance services beyond the warranty period will be subject to charges.

1. "The Company" shall not be liable for any direct or indirect loss or damage to any person or property, whatsoever caused arising from improper use, or any stoppage, breakdown or failure of the product.
2. Customers are responsible to deliver the product to our service centres or designated stores, and to pick up the repaired product from the same location.
3. For any defect which in our judgment is caused under normal use, "The Company" will repair or replace the defective parts, free of charge within the warranty period (excluding any surface, cabinet, consumptive parts, accessories and consumable).
4. Warranty service does not cover the following items. Additional charges shall be levied if services are required.
 - (a) The product has been modified, tempered with, altered or repaired in any way by unauthorised persons.
 - (b) The product has been damaged through misuse, negligence, neglect of care after use, power interruption or abnormal voltage input, accident, natural calamities, or due to ingress of insects, foreign matters or liquid, corrosion, normal wear and tear or external factors.
 - (c) The product has been damaged due to use contrary to the instructions in this manual.
5. All terms stated are subject to change without notice. In case of any dispute, the decision of Savewo Distribution Limited shall be final.

The warranty does not apply under the following circumstances:

1. Cases of battery discharge due to lights or other equipment left on, and recovery through recharging.
2. Cases of misuse, improper use, or negligence, including but not limited to:
 - a. Issues caused by faulty electrical systems, defects, or unauthorized modifications.
 - b. Modifying the battery or applying excessive electrical load.
 - c. Physical damage to the battery.
 - d. Overcharging, deep discharging, or prolonged discharge without recharging.
 - e. Extended periods of vehicle inactivity resulting in discharge due to standby current draw.
 - f. Reverse polarity charging.
3. Issues caused by vehicle-side problems, including but not limited to:
 - a. Regulator output voltage exceeding standard limits, causing overcharging.
 - b. Repeated battery discharge incidents.
4. Cases where the vehicle condition prevents identification of the cause of the issue.
5. Damage caused by natural disasters (e.g., earthquakes, typhoons, floods), fire, accidents, or civil unrest.
6. Installation of the battery in a vehicle not covered by the warranty certificate.

In order to ensure that you can fully understand and use this product correctly, please read this manual carefully, and it is recommended to keep this manual properly for reference when needed.

※Differences may arise due to product updates. Please refer to the actual product for accurate information.

Customer Service and After-Sales Support Hotline

SAVEWO LIMITED Customer Service Center

Address : 1/F, 266-270 Texaco Road, Tsuen Wan, N.T., Hong Kong

Hotline : +852 5503 2370

www.savewo.com



Savewo



savewohk



CARCELL



www.savewo.com | store.savewo.com

+852 6487 8597

 Savewo

 savewohk